

NewNight® Pole top luminaire PIN-BOARD 1S

BRAUN Lighting Solutions Streets - Car Park - Residential- and District Lighting

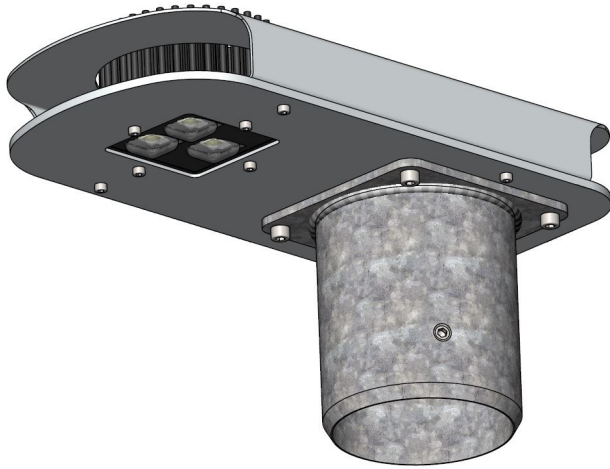

- Pole top luminaire of the newest generation
- FuturePROOF > all components independently changeable
- Ready for connection and easy to install and maintain
- Easy integration into existing lighting towers
- Low weight and low wind load
- Highest efficiency of all system components - LongLIFE
- BRAUN® 3LENS PIN-Modul LS12
- Different light distributions possible
- Changeable LED-Module with FlexPIN Technology
- High-performance lens system made of PMMA (UV-resistant)
- ThermoProtect System against overtemperature of the LED
- Vibration-resistant
- Lifetime L80: 60.000 - 100.000 h

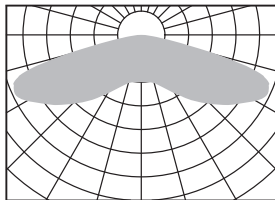

LS12 ME600
Lighting for one or two-sided arrangement of poles, also with lower mounting heights and larger distances

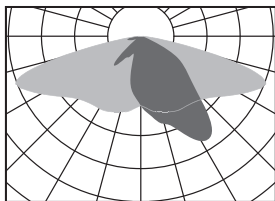

LS12 ME612
Lighting for pedestrian and bicycle paths with one sided arrangement of poles, also with lower mounting heights and larger distances



NewNight® Pole top luminaire PIN-BOARD 1S	Eco	Basic E1	Light E2	DALI
Power consumption	30W	5-30W	5-30W	1-30W
Luminous flux on 4000K	2538lm	2538lm	2538lm	2538lm
Recommended mounting height	3...5m	3...5m	3...5m	3...5m
Power control options Dimming				
manually via 10-step coding switch		•	•	
Phase controlled night-time light reducing (half-night switch, 230VAC)			•	
Dimming manually via 10-step coding switch			•	
AstroDimm - programmable dimming levels	•	•	•	•
0-10V 1-10V Interface	•			
DALI interface				•
Light color				
2700K, 3000K, 3500K, 4000K, 5000K, 5700K	•	•	•	•
Applications - Light distributions - symmetrical und asymmetrical				
For residential and residential streets as well as district lighting	•	•	•	•
For pedestrian and bicycle paths as well as for parks and green areas	•	•	•	•

Braun Lighting Solutions e. K. is a participant in the export initiative "Energie Effizienz – made in Germany", initiated by the Federal Ministry for the Economy and Technology.
*Due to the complexity of the many possible combinations of drivers and LED modules, the values shown for technical LED parameters, including performance parameters, are typical. Actual values of specific products in specific configurations may vary from these typical values. The information and diagrams contained in this document do not constitute an offer or contractual obligation. Product parameters may change as a result of technical innovation and will be undertaken without prior notice. Our manufacturing conforms to DIN EN and VDE regulations; the product conforms to European EMC regulations.

NewNight® Pole top luminaire PIN-BOARD 1S

BRAUN Lighting Solutions Streets - Car Park - Residential- and District Lighting

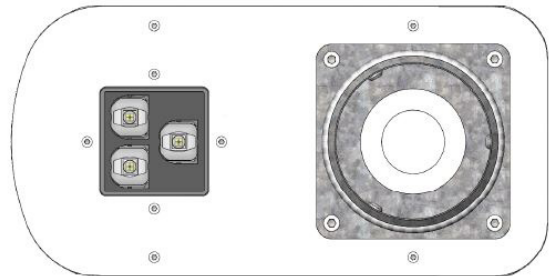
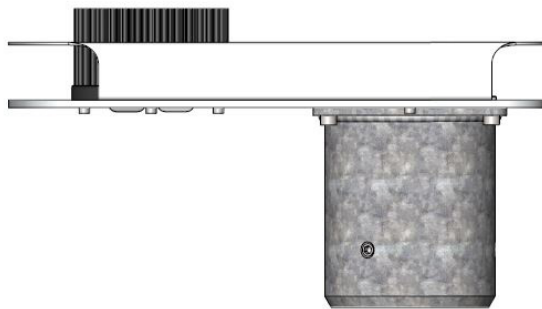

Optional equipment

Basic E1: Power consumption adjustable - manually adjustable of basic brightness

Light E2: Power consumption adjustable - manually adjustable of basic brightness and reduced brightness

DALI: Interface wire to wire

Surge protection 10kA

Adapter for spigot Ø60mm

Special painting

Freely selectable light distributions

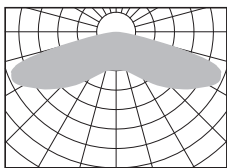

LS12 ME 600

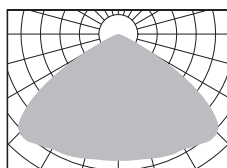

LS12 ME 601

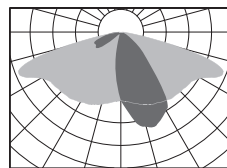

LS12 ME 610

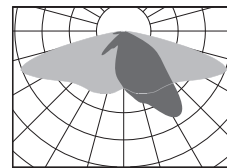

LS12 ME 612

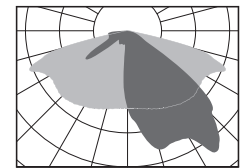

LS12 ME 616

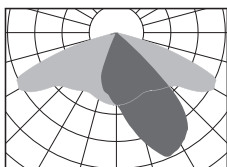

LS12 ME 618

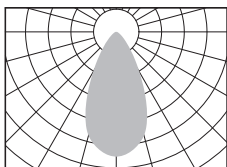

LS12 ME 624

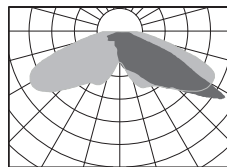

LS12 ME 630

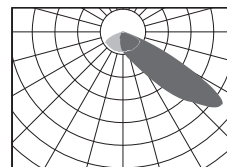

LS12 ME 640

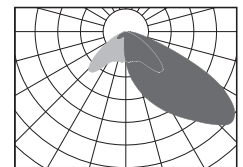

LS12 ME 641

TECHNICAL DESCRIPTION

Power consumption:

30 Watt

Luminous flux:

2538lm on 4000K

Light color:

2700K | 3000K | 3500K | 4000K | 5000K | 5700K

Switching function:

Eco (on/off) | Basic E1 | Light E2 | DALI

Permissible operating voltage:

90-305VAC, 50/60Hz

Permissible ambient temperature:

-40°C up to 50°C

PIN-Modul degree of protection | Protection class:

IP67 | Protection class I (Protection class II on demand)

Optical cover:

High-performance lens system PMMA (UV-resistant)

Housing:

aluminium, paintwork according to nach RAL or DB

Adapter for spigot Ø60mm:

Ø76mm

Main dimensions LxWxH (without spigot):

280mm x 54mm x 140mm

Weight:

1,7kg

Braun Lighting Solutions e. K. is a participant in the export initiative "Energie Effizienz – made in Germany", initiated by the Federal Ministry for the Economy and Technology.

*Due to the complexity of the many possible combinations of drivers and LED modules, the values shown for technical LED parameters, including performance parameters, are typical. Actual values of specific products in specific configurations may vary from these typical values. The information and diagrams contained in this document do not constitute an offer or contractual obligation. Product parameters may change as a result of technical innovation and will be undertaken without prior notice. Our manufacturing conforms to DIN EN and VDE regulations; the product conforms to European EMC regulations.